

**Geo Referenced Cadastral Map of Vagachiper Mining Lease, bearing T.C. No. 12 of 1941, situated in Bicholim, Bordem, Lamgao & Mayem Villages of Bicholim Taluka, North Goa District, Goa State.**

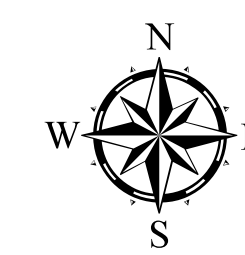

SCALE 1:3,960

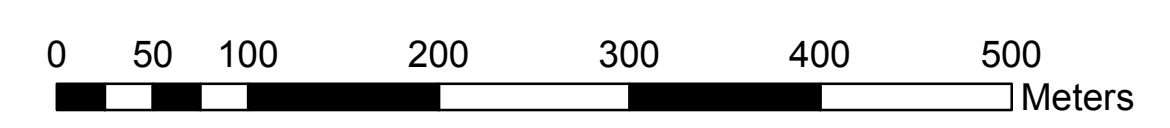

**Legend**

- DGPS POINT OF LEASE BOUNDARY
- LEASE BOUNDARY AS PER DGPS SURVEY
- ADJACENT LEASE BOUNDARY
- SURVEY No BOUNDARY
- SUB-DIVISION OF THE SURVEY No
- TALUKABOUNDARY
- VILLAGE BOUNDARY

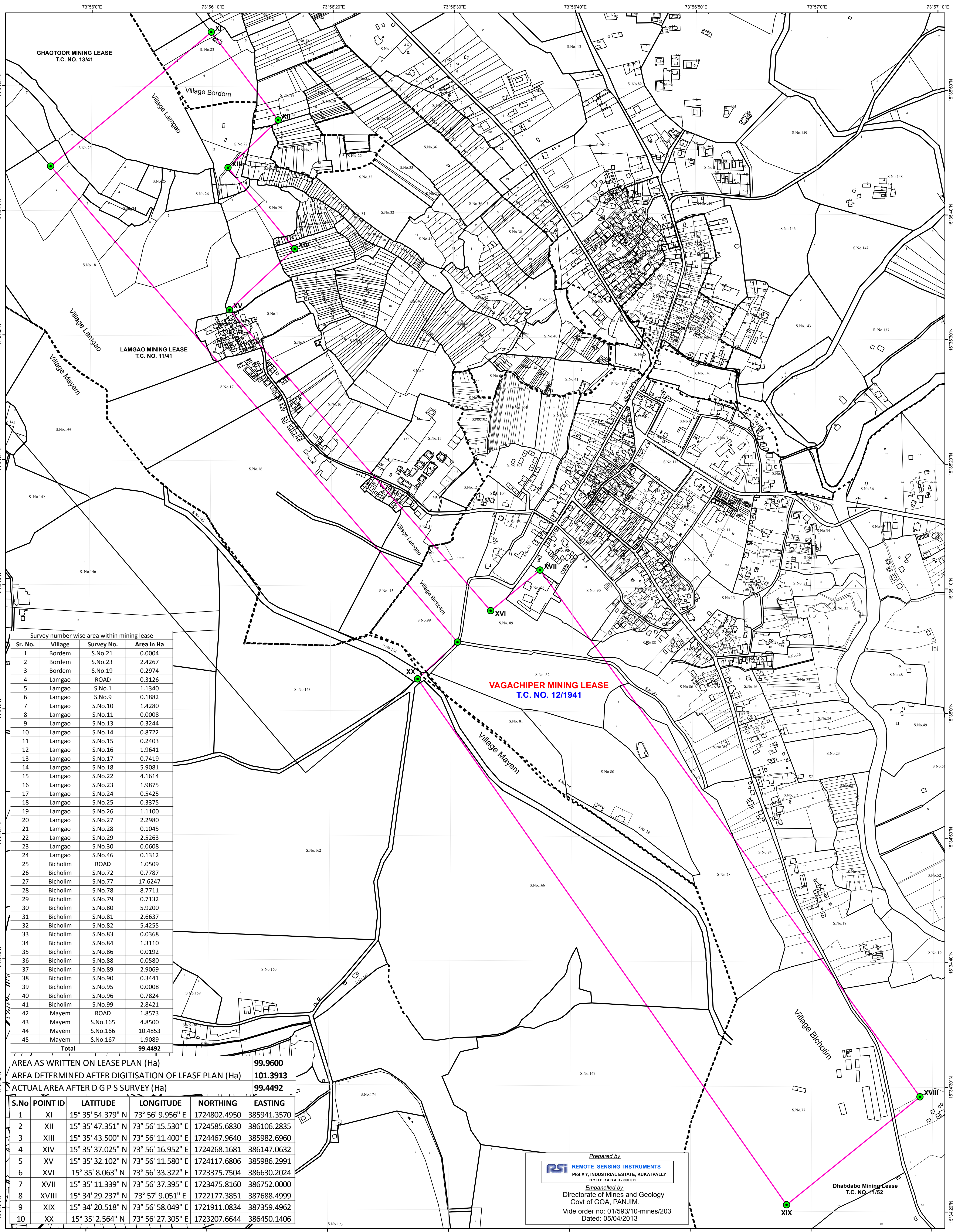

Sr. No.	Village	Survey No.	Area in Ha
1	Bordem	S.No.21	0.0004
2	Bordem	S.No.23	2.4267
3	Bordem	S.No.19	0.2974
4	Lamgao	ROAD	0.3126
5	Lamgao	S.No.1	1.1340
6	Lamgao	S.No.9	0.1882
7	Lamgao	S.No.10	1.4280
8	Lamgao	S.No.11	0.0008
9	Lamgao	S.No.13	0.3244
10	Lamgao	S.No.14	0.8722
11	Lamgao	S.No.15	0.2403
12	Lamgao	S.No.16	1.9641
13	Lamgao	S.No.17	0.7419
14	Lamgao	S.No.18	5.9081
15	Lamgao	S.No.22	4.1614
16	Lamgao	S.No.23	1.9875
17	Lamgao	S.No.24	0.5425
18	Lamgao	S.No.25	0.3375
19	Lamgao	S.No.26	1.1100
20	Lamgao	S.No.27	2.2980
21	Lamgao	S.No.28	0.1045
22	Lamgao	S.No.29	2.5263
23	Lamgao	S.No.30	0.0608
24	Lamgao	S.No.46	0.1312
25	Bicholim	ROAD	1.0509
26	Bicholim	S.No.72	0.7787
27	Bicholim	S.No.77	17.6247
28	Bicholim	S.No.78	8.7711
29	Bicholim	S.No.79	0.7132
30	Bicholim	S.No.80	5.9200
31	Bicholim	S.No.81	2.6637
32	Bicholim	S.No.82	5.4255
33	Bicholim	S.No.83	0.0368
34	Bicholim	S.No.84	1.3110
35	Bicholim	S.No.86	0.0192
36	Bicholim	S.No.88	0.0580
37	Bicholim	S.No.89	2.9069
38	Bicholim	S.No.90	0.3441
39	Bicholim	S.No.95	0.0008
40	Bicholim	S.No.96	0.7824
41	Bicholim	S.No.99	2.8421
42	Mayem	ROAD	1.8573
43	Mayem	S.No.165	4.8500
44	Mayem	S.No.166	10.4853
45	Mayem	S.No.167	1.9089
<b>Total</b>			<b>99.4492</b>

AREA AS WRITTEN ON LEASE PLAN (Ha) **99.9600**  
 AREA DETERMINED AFTER DIGITISATION OF LEASE PLAN (Ha) **101.3913**  
 ACTUAL AREA AFTER D G P S SURVEY (Ha) **99.4492**

S.No	POINT ID	LATITUDE	LONGITUDE	NORTHING	EASTING
1	XI	15° 35' 54.379" N	73° 56' 9.956" E	1724802.4950	385941.3570
2	XII	15° 35' 47.351" N	73° 56' 15.530" E	1724585.6830	386106.2835
3	XIII	15° 35' 43.500" N	73° 56' 11.400" E	1724467.9640	385982.6960
4	XIV	15° 35' 37.025" N	73° 56' 16.952" E	1724268.1681	386147.0632
5	XV	15° 35' 32.102" N	73° 56' 11.580" E	1724117.6806	385986.2991
6	XVI	15° 35' 8.063" N	73° 56' 33.322" E	1723375.7504	386630.2024
7	XVII	15° 35' 11.339" N	73° 56' 37.395" E	1723475.8160	386752.0000
8	XVIII	15° 34' 29.237" N	73° 57' 9.051" E	1722177.3851	387688.4999
9	XIX	15° 34' 20.518" N	73° 56' 58.049" E	1721911.0834	387359.4962
10	XX	15° 35' 2.564" N	73° 56' 27.305" E	1723207.6644	386450.1406

Prepared by  
**RSI REMOTE SENSING INSTRUMENTS**  
 Plot # 7, INDUSTRIAL ESTATE, KUKATPALLY  
 HYDERABAD - 500 072  
 Entitled to  
 Directorate of Mines and Geology  
 Govt of GOA, PANJIM.  
 Vide order no: 01/593/10-mines/203  
 Dated: 05/04/2013

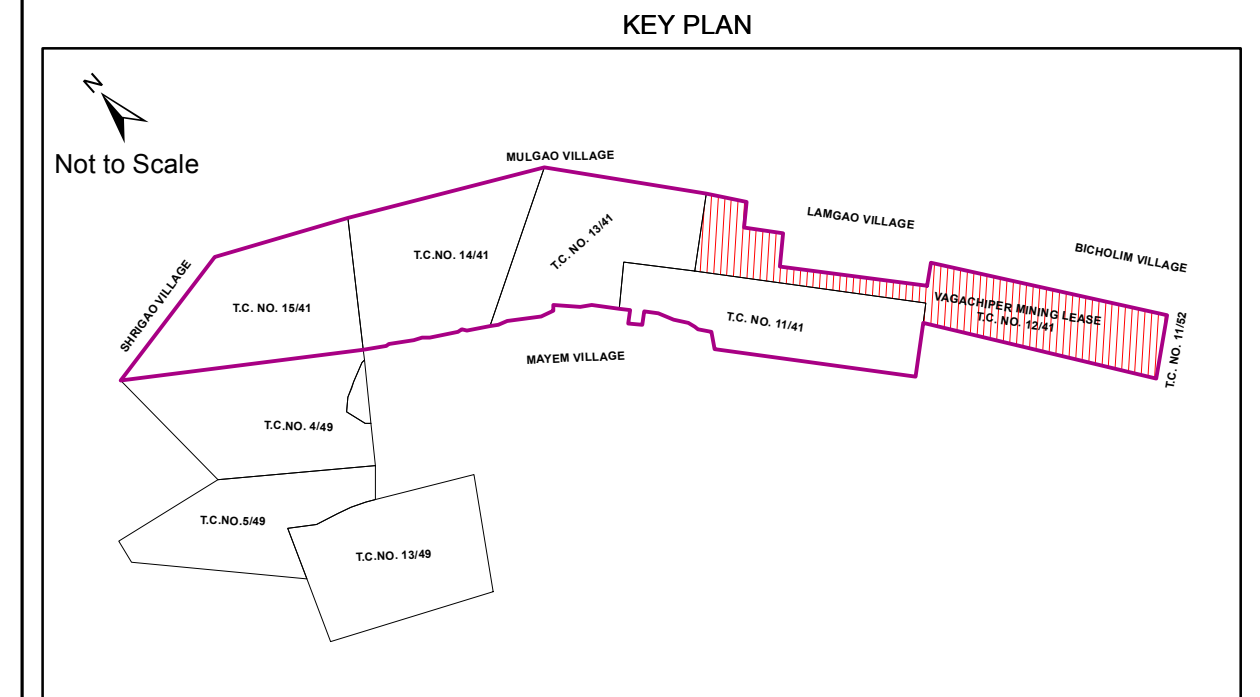

**DATUM : WGS 84**  
**PROJECTION : UTM\_Zone\_43N**

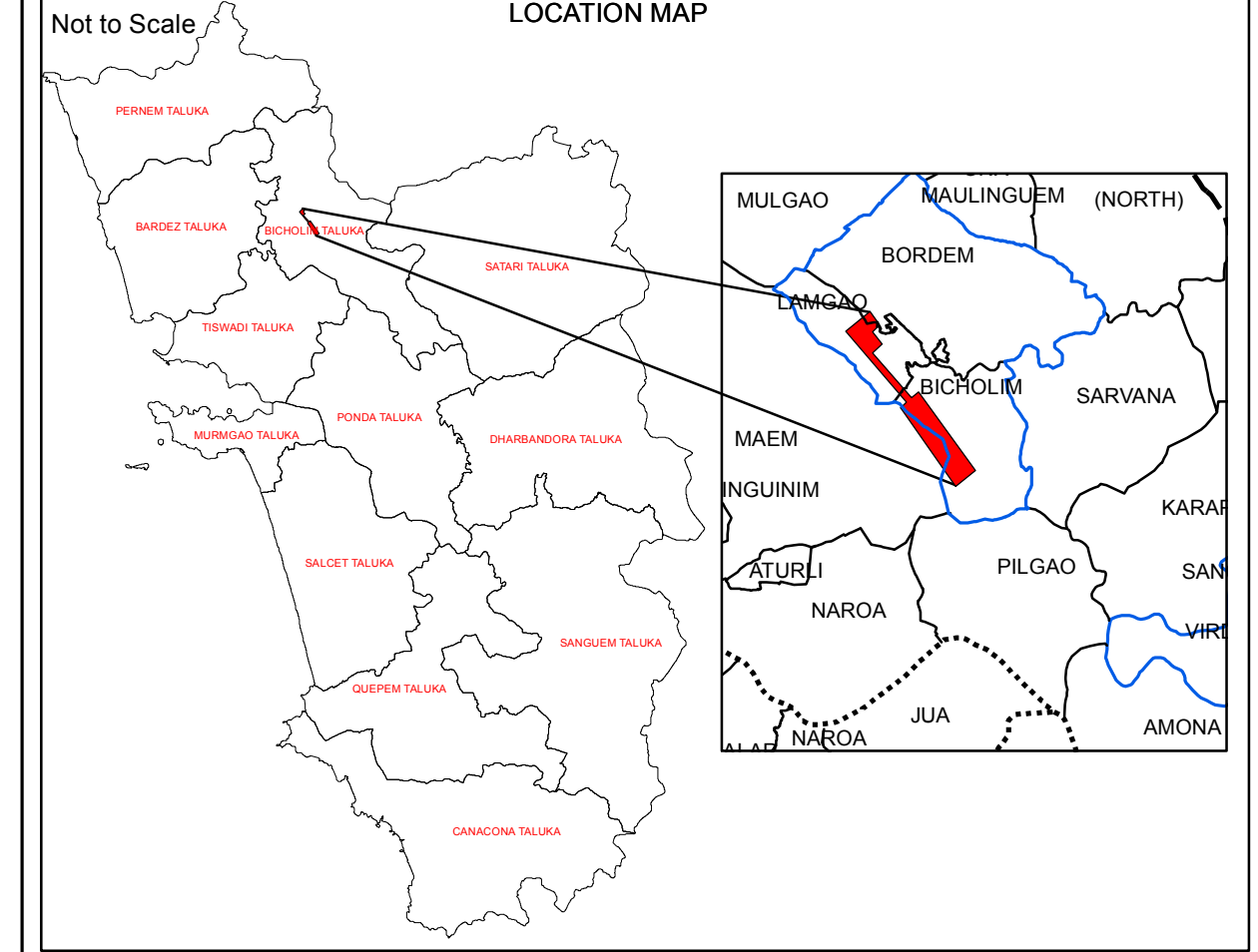

**CERTIFICATE**

This is to certify that the lease boundary pillars of T.C. No. 12 of 1941 have been surveyed using DGPS (Differential Global Positioning System) and is based upon the Total Station survey conducted earlier.

Mr. Shrishaila Gowda  
(Mines Manager)

Note: Bicholim Mine is consisting of 5 Contiguous Leases bearing T.C. Nos. 11/41, 12/41, 13/41, 14/41 & 15/41.

**CERTIFICATE**

This is to certify that the lease boundary pillars of T.C. No. 12 of 1941, shown by Mr. Shrishaila Gowda (Mines Manager) has been surveyed by our team led by Shri. Ch. Sivaiah using DGPS (Differential Global Positioning System) instruments. The lease map and pillar locations have been verified, survey conducted and plans prepared as per requirement of IBM Circular No. 2/2010 dated 6-4-2010.

For Remote Sensing Instruments  
 Shri. B.V Ramana Kumar  
(General Manager)

Directorate of Mines and Geology - Panaji - Goa	
Checked by	Certified by
Surveying officer	Director of Mines and Geology